

# Assembly Instructions

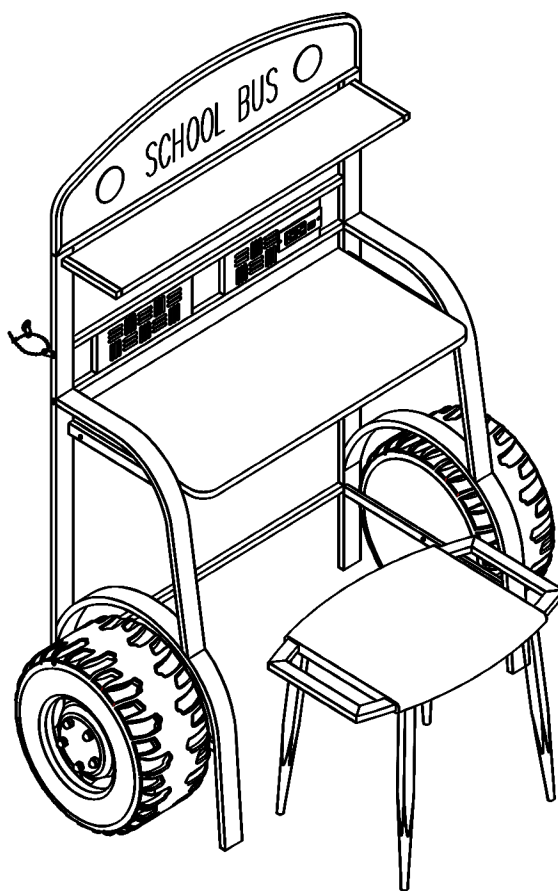

## ASSEMBLY RATING

The Assembly Rating is a 5-point system that shows the degree of effort needed in assembling a specific product (with 1 being easy and 5 being difficult). For some products, two persons are recommended.

EASY



DIFFICULT

## Tools Required For Assembly:

Allen Wrench



(Included)

Phillips Screwdriver



(Not Included)



2 PERSONS RECOMMENDED

# ASSEMBLY & CARE ADVICE

FOR YOUR FURNITURE TO LAST, CORRECT ASSEMBLY AND PROPER MAINTENANCE ARE NECESSARY. PLEASE FOLLOW THE INFORMATION PROVIDED BELOW TO FULLY ENJOY YOUR FURNITURE.

## BASIC ASSEMBLY TECHNIQUES

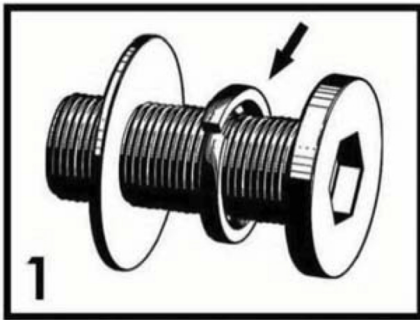

When lock or spring washer is used in an assembly, please make sure the lock or spring washer is placed between the larger flat washer and the head of the screw or bolt.

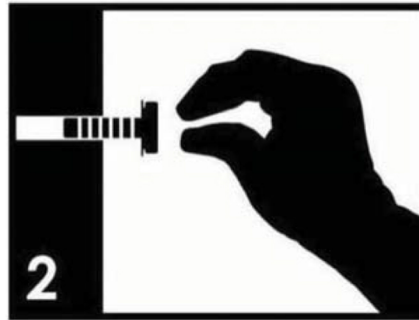

Position each part correctly and insert screws or bolts into their respective holes by hand tighten or using the proper hand tool. Only tighten when step is completed or when instructed to do so.

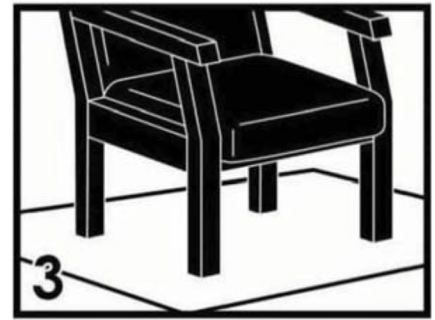

Use cardboard or carpet area when assembling furniture to prevent scratches. Make sure the furniture rests on a flat and level surface with each leg evenly touching the floor.

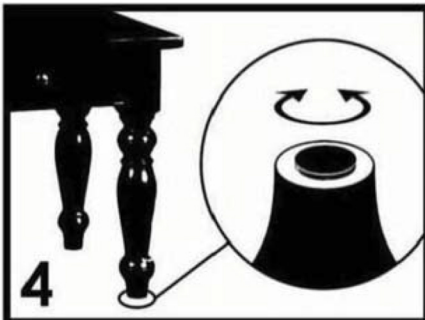

Some furniture comes with height adjustment knobs underneath each leg. To lower or to raise each leg, you need to turn clockwise or counterclockwise, respectively.

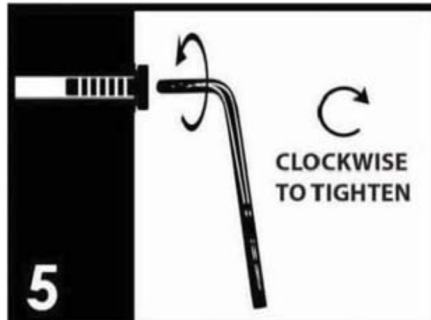

Make sure all parts are properly aligned, then use the appropriate hand tool to completely tighten the bolts or screws. Do not use power tools and do not overtighten.

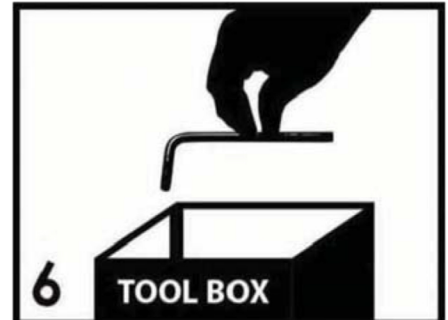

Save the instructions and store the Allen wrench or any supplied tool for later maintenance. After two weeks, check and tighten any loose hardware and repeat again every six months thereafter.

IT IS THE USER'S RESPONSIBILITY TO MAINTAIN THE FURNITURE. THE HARDWARE MAY LOOSEN OVER TIME AND MAY CAUSE THE FURNITURE TO BE WOBBLY AND UNABLE TO SUPPORT ITS INTENDED WEIGHT CAPACITY. THIS MAY LEAD TO COLLAPSE AND MAY CAUSE SERIOUS INJURY.



FAILURE TO FOLLOW THE GUIDELINES ABOVE MAY RESULT IN INJURY AND/OR PROPERTY DAMAGE.



Before you begin, please read Page 2 of "Assembly and Care Advice".

And remember, do not tighten until each step is completed or instructed.

## Parts List

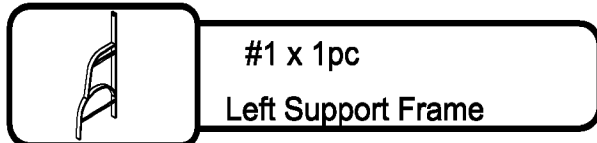

#1 x 1pc  
Left Support Frame

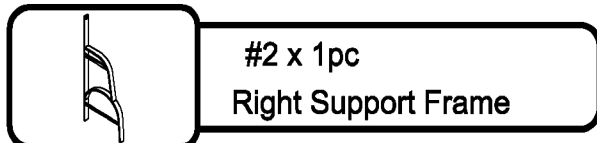

#2 x 1pc  
Right Support Frame

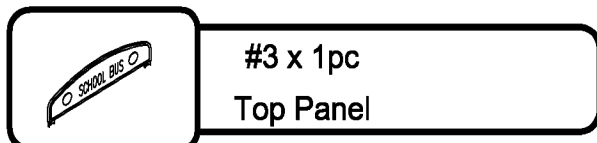

#3 x 1pc  
Top Panel

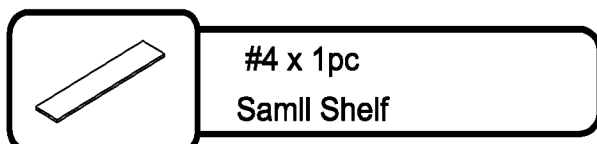

#4 x 1pc  
Small Shelf

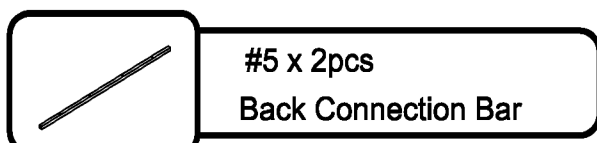

#5 x 2pcs  
Back Connection Bar

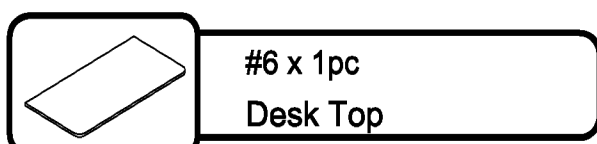

#6 x 1pc  
Desk Top

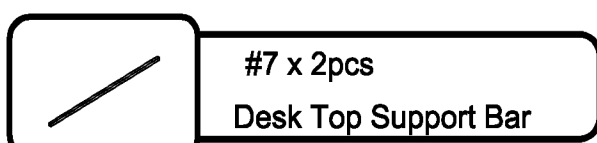

#7 x 2pcs  
Desk Top Support Bar

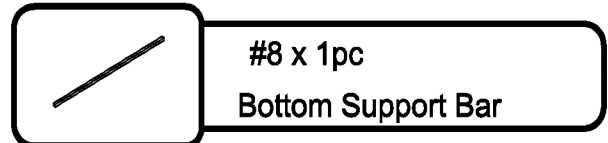

#8 x 1pc  
Bottom Support Bar

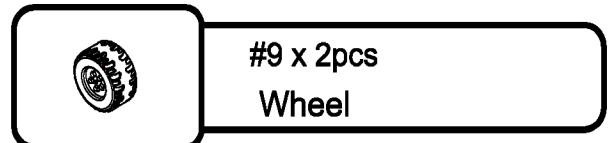

#9 x 2pcs  
Wheel

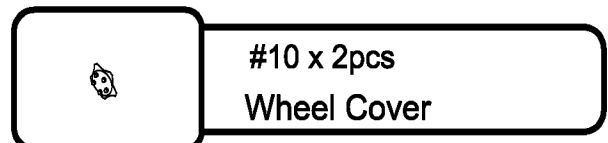

#10 x 2pcs  
Wheel Cover

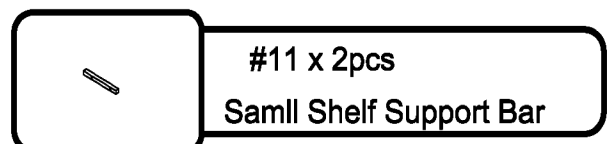

#11 x 2pcs  
Small Shelf Support Bar

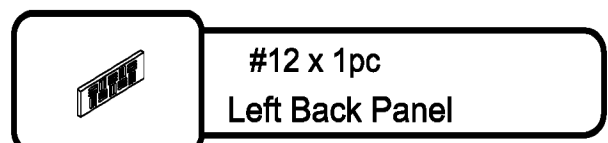

#12 x 1pc  
Left Back Panel

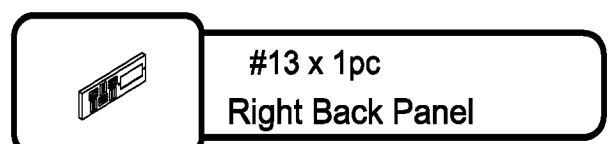

#13 x 1pc  
Right Back Panel

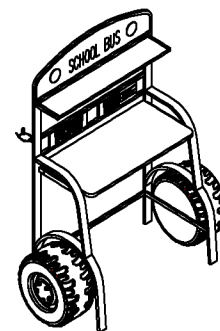

## Hardware List

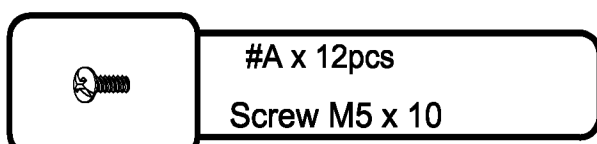

#A x 12pcs  
Screw M5 x 10

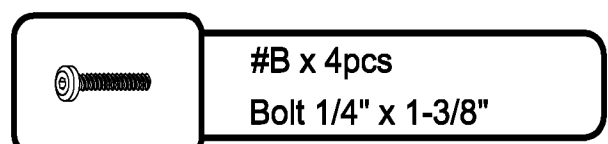

#B x 4pcs  
Bolt 1/4" x 1-3/8"



Before you begin, please read Page 2 of "Assembly and Care Advice".

And remember, do not tighten until each step is completed or instructed.



#C x 6pcs  
Bolt 1/4" x 3"



#K x 1pc  
Explosive Nut



#D x 1pc  
Allen Wrench M4



#L x 1pc  
Tipping Restraint



#E x 8pcs  
Screw M4 x 25



#M x 6pcs  
Flat Washer



#F x 1pc  
Socket

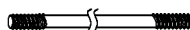

#N x 2pcs  
Stud Bolt 5/16" X 8-1/2"



#G x 2pcs  
Screw M3 x 10



#O x 1pc  
Allen Wrench M5



#H x 2pcs  
Hex Nut



#P x 2pcs  
Bolt 5/16" X 3/4"



#I x 1pc  
Screw M4 x 37



#Q x 2pcs  
Bolt 1/4" X 3/4"



#J x 2pcs  
Keyhole Slot





#1

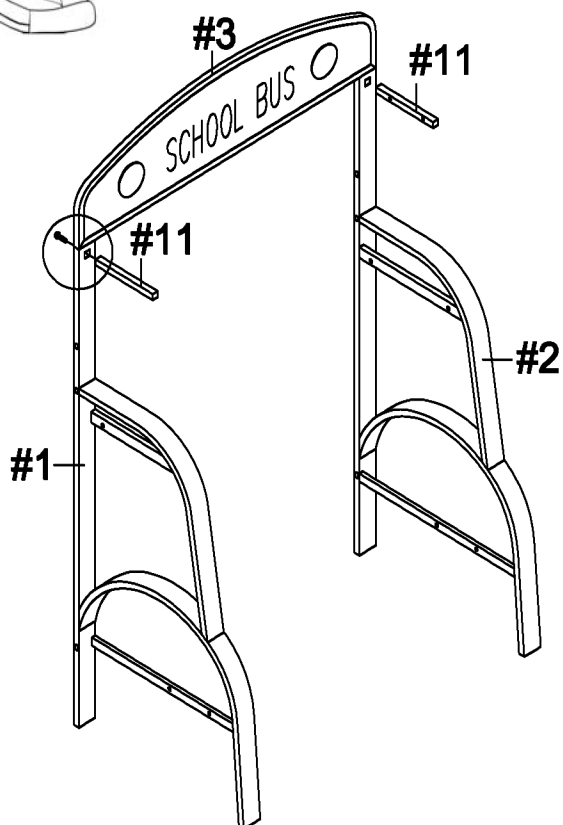

1-1

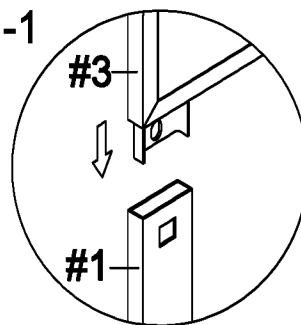

#Q x 2pcs

1. Insert the top panel (#3) into the top of the left and right support frames (#1,2).

1-2

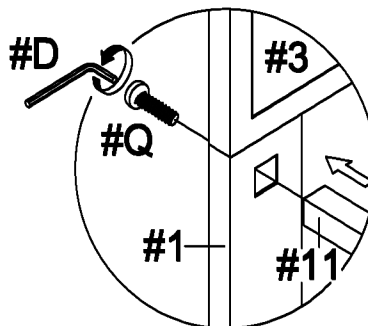

2. Insert a bolt (#Q) into each end from the back, then secure using the Allen wrench (#D).



#2

#A x 12pcs  
#C x 6pcs  
#J x 1pc

3. Align the back panels (#12,13) to the holes along the top of the left and right support frames (#1,2). Then apply a keyhole slot (#J) into 2 bolts (#C), insert those into the upper holes and insert a bolt (#C) into the lower holes. Secure using the Allen wrench (#D).

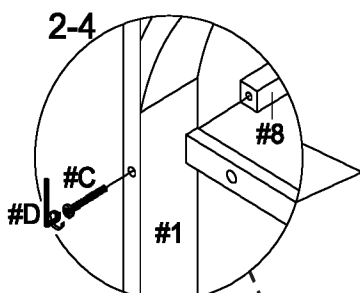
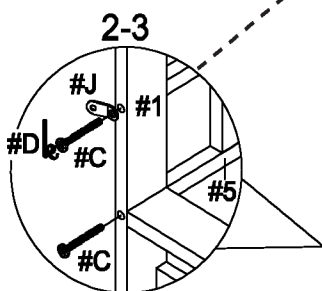

4. Align the bottom support bar (#8) to the holes along the bottom of the left and right support frames (#1,2). Then insert a bolt (#C) into the holes. Secure using the Allen wrench.

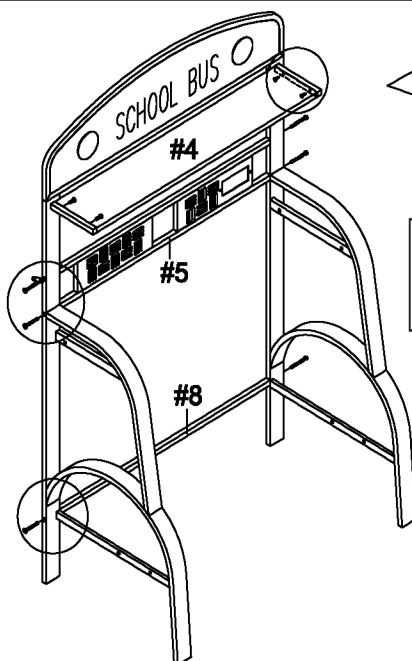

2-2

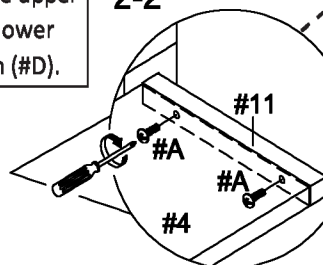

2. Align the small shelf (#4) to the holes along the top of the left and right support frames (#1,2). Then insert 2 screws (#A) into the holes. Secure using a Phillips screwdriver.

1. Apply the left and right back panels (#12,13) onto the back connection bars (#5). Then insert screws (#A) and secure using a screwdriver.

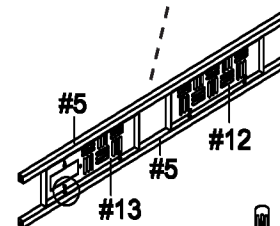

2-1

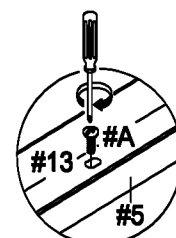



Align the desktop support bars (#7) to the holes along the center of the left and right support frames (#1,2). Then insert a bolt (#B) into each end. Secure using the Allen wrench (#D).

#B x 4pcs

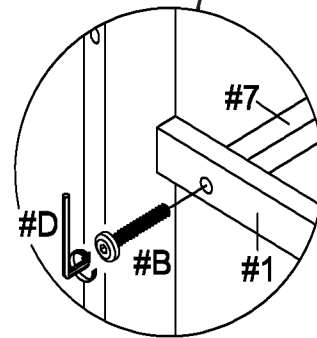
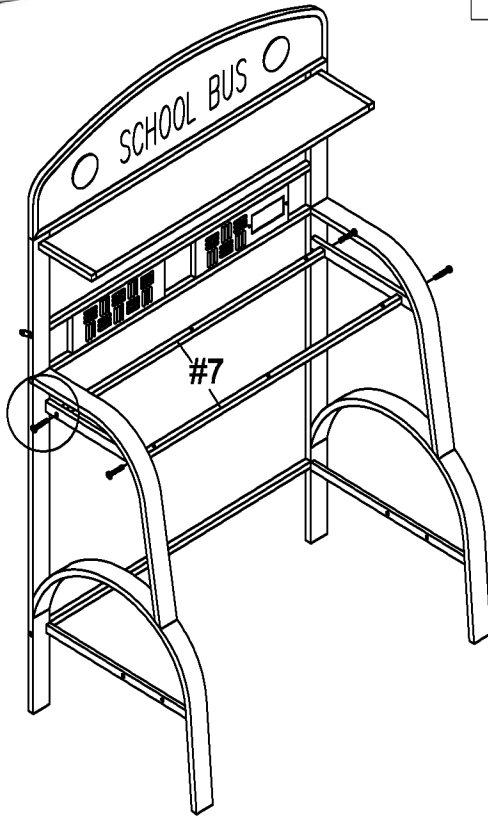

2. Align the socket (#F) to the holes along the right back panel (#13), then insert 2 screws (#G) and secure using a Phillips screwdriver. On the other side apply a hex nut (#H) onto each screw and tighten.

#E x 6pcs  
#F x 1pc  
#G x 2pcs  
#H x 2pcs  
#M x 6pcs

4-2

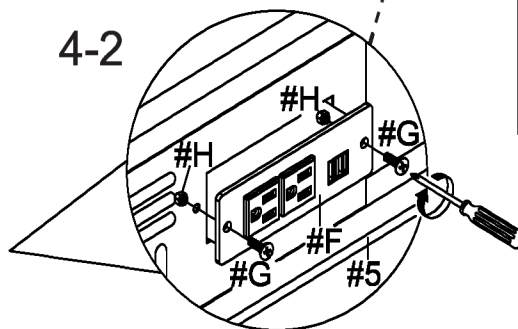

4-1

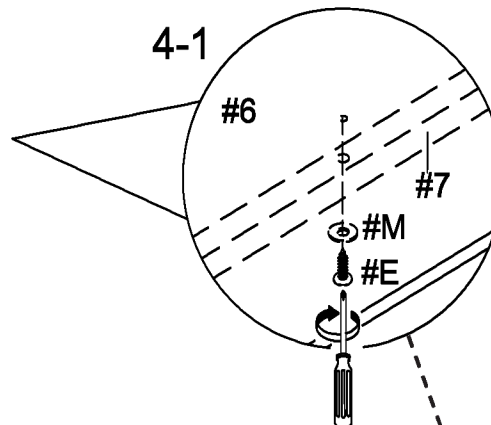

1. Place the desk top (#6) onto the support bars (#7). Then prepare 6 screws by inserting a flat washer (#M) onto the screws (#E), after that insert into the holes from below into the bars and secure using a Phillips screwdriver.



1. Insert a threaded end of the stub bolt (#N) into the wheel cover (#10), turn right to tighten.

#E x 2pcs  
#N x 2pcs  
#P x 2pcs

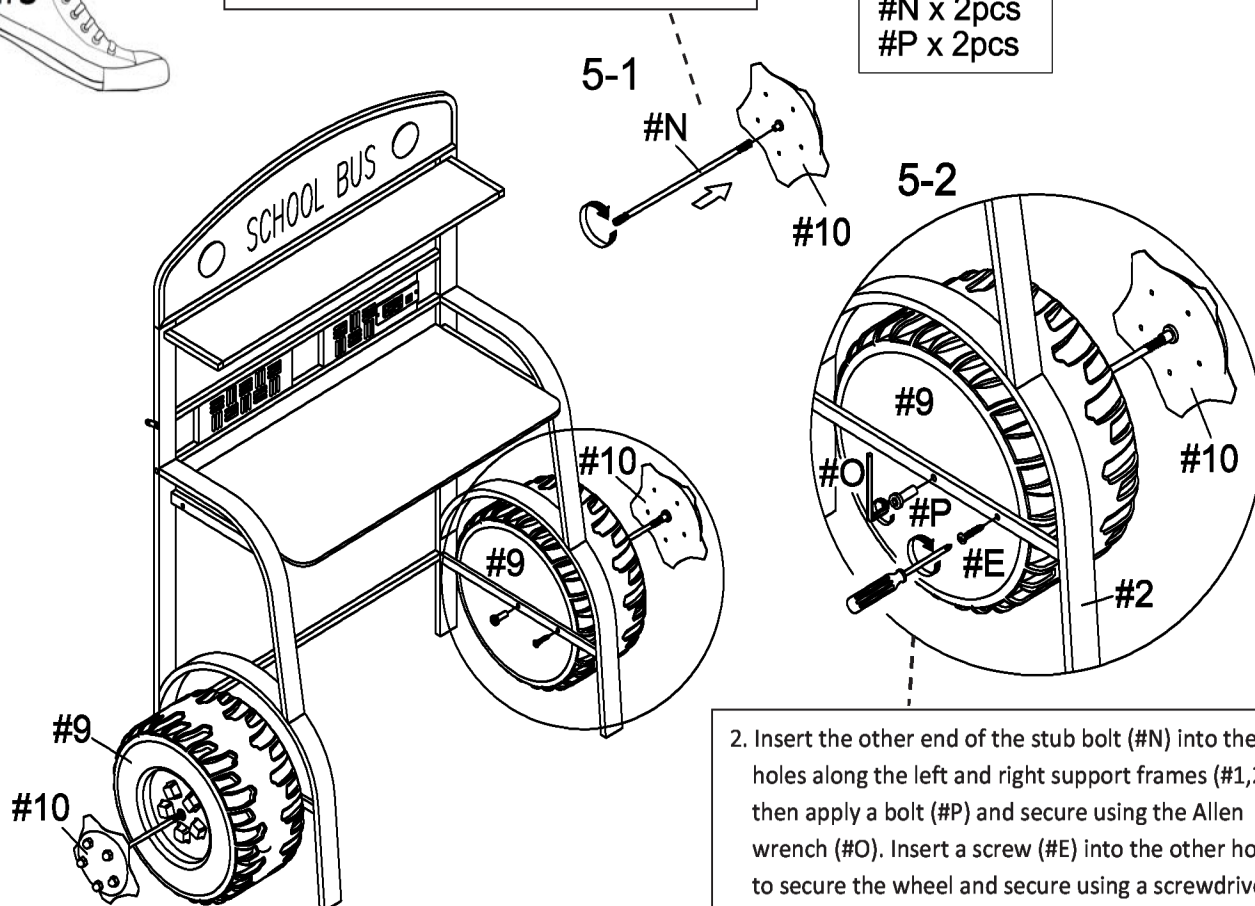

2. Insert the other end of the stub bolt (#N) into the holes along the left and right support frames (#1,2), then apply a bolt (#P) and secure using the Allen wrench (#O). Insert a screw (#E) into the other holes to secure the wheel and secure using a screwdriver.

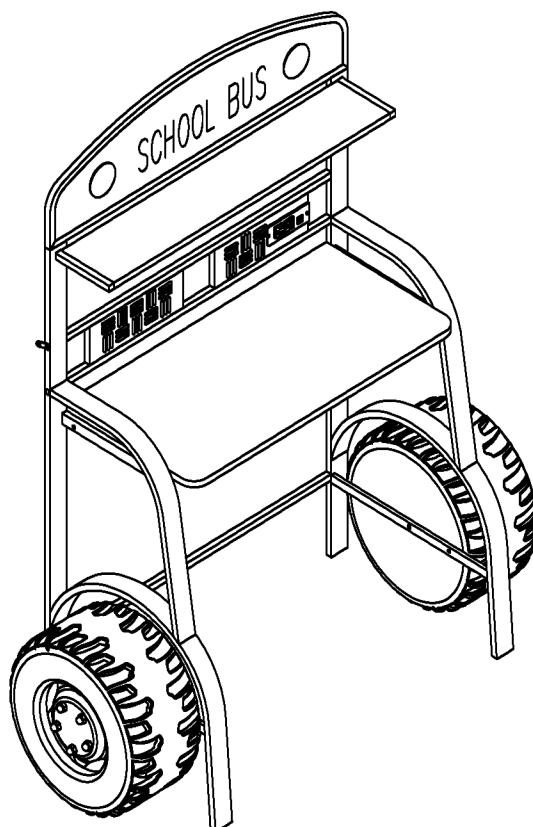

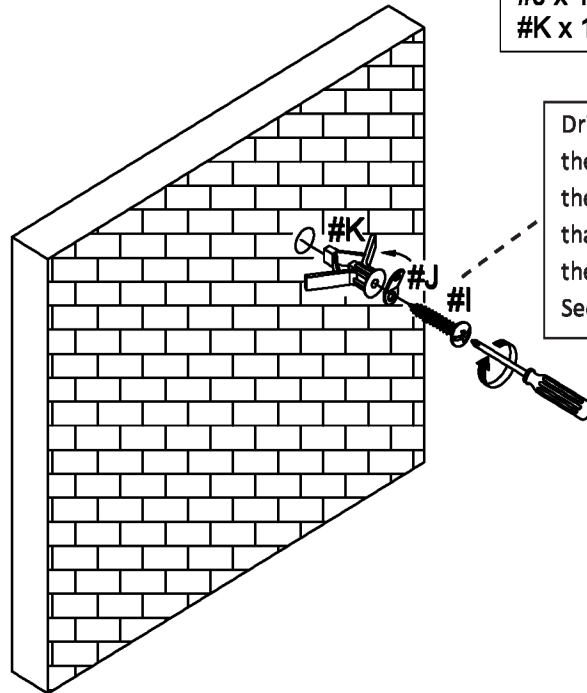

#I x 1pc  
#J x 1pc  
#K x 1pc

Drill a hole slightly smaller than the explosive nut (#K), then push the nut (#K) into the hole. After that align a keyhole slot (#J) to the nut and insert a screw (#I). Secure using a Phillips screwdriver.

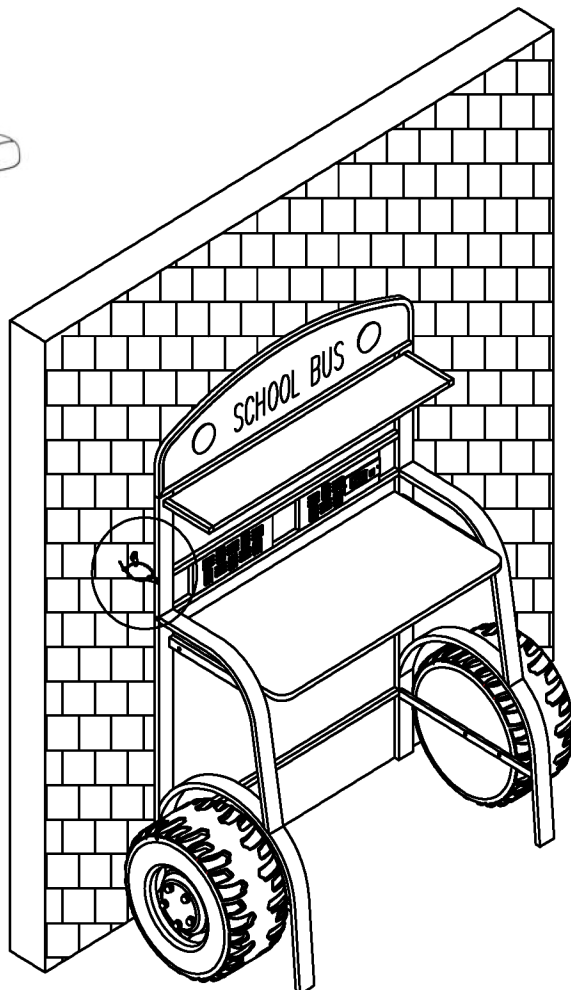

#L x 1pc

To Prevent Tip over  
Product Must Be  
Attached To Wall

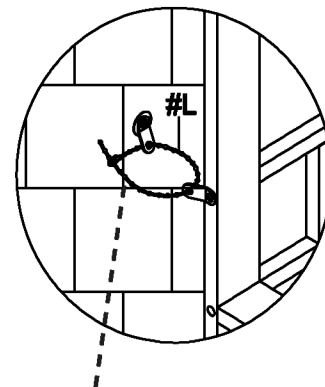

Place the keyhole slots (#J) near each other and insert a tipping restraint (#L). Secure accordingly.



Before you begin, please read Page 2 of "Assembly and Care Advice".

And remember, do not tighten until each step is completed or instructed.

## Parts List

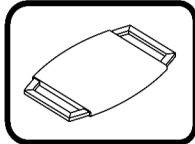

#1 x 1pc  
Seat

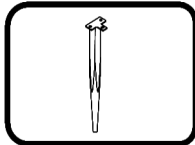

#2 x 4pcs  
Leg

## Hardware List

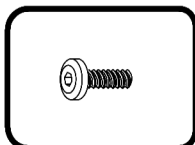

#A x 8pcs  
Bolt 1/4" X 5/8"

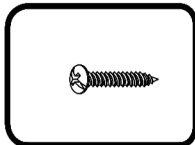

#B x 4pcs  
Screw M5x20

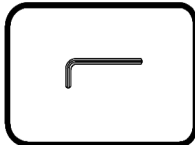

#C x 1pc  
Allen Wrench M4

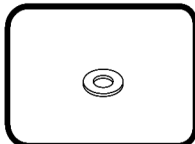

#D x 4pcs  
Flat Washer

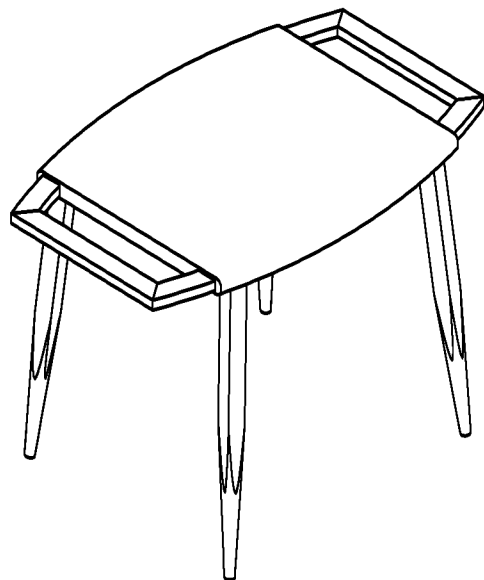



1. Place the seat (#1) face down onto a protected surface.

#A x 8pcs  
#B x 4pcs  
#D x 4pcs

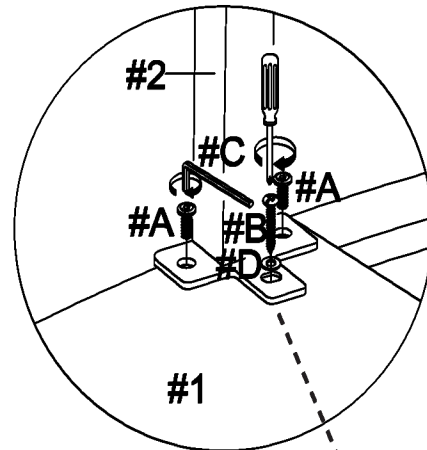
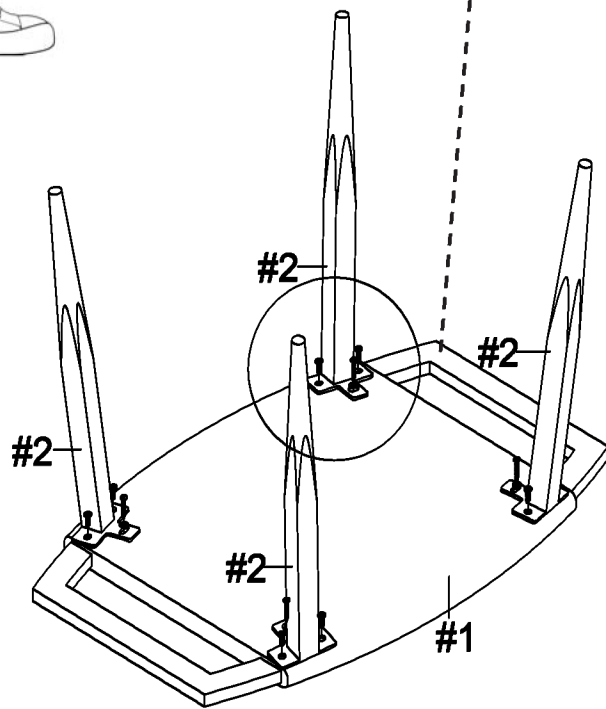

2. Align the legs (#2) face down to the holes along the bottom of the seat, then insert 2 bolts (#A) into the outer holes and a screw (#B) into the front hole. Secure using the Allen wrench (#C) and screwdriver.



Turn upright and make sure all parts are firmly secured.

