

# Assembly Instructions

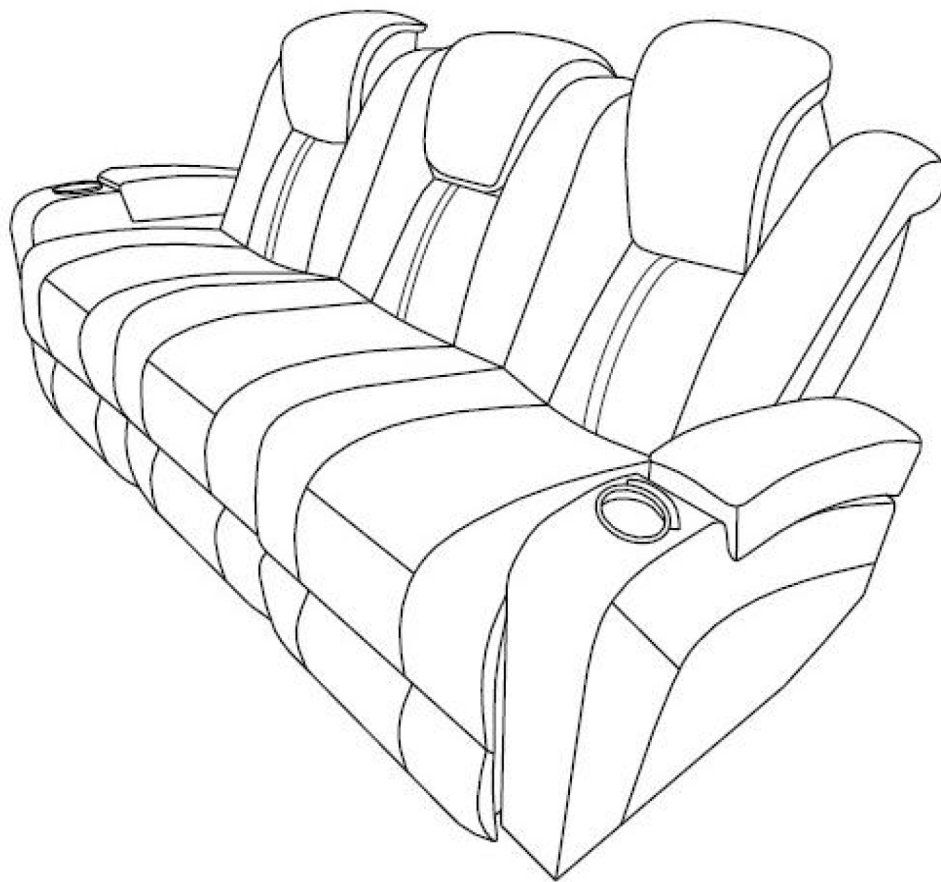

## ASSEMBLY RATING

The Assembly Rating is a 5-point system that shows the degree of effort needed in assembling a specific product (with 1 being easy and 5 being difficult). For some products, two persons are recommended.

EASY  DIFFICULT

No Tools Required for Assembly



2 PERSONS RECOMMENDED

# ASSEMBLY & CARE ADVICE

FOR YOUR FURNITURE TO LAST, CORRECT ASSEMBLY AND PROPER MAINTENANCE ARE NECESSARY. PLEASE FOLLOW THE INFORMATION PROVIDED BELOW TO FULLY ENJOY YOUR FURNITURE.

## BASIC ASSEMBLY TECHNIQUES

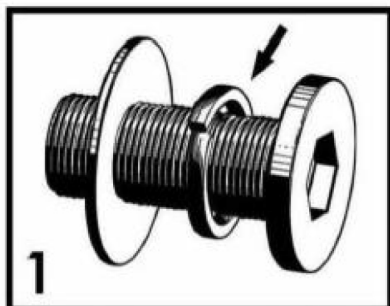

When lock or spring washer is used in an assembly, please make sure the lock or spring washer is placed between the larger flat washer and the head of the screw or bolt.

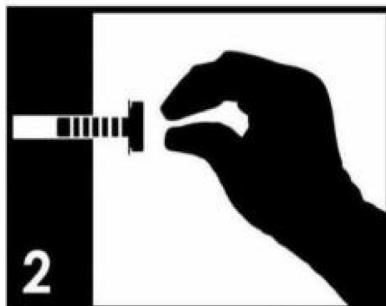

Position each part correctly and insert screws or bolts into their respective holes by hand tighten or using the proper hand tool. Only tighten when step is completed or when instructed to do so.

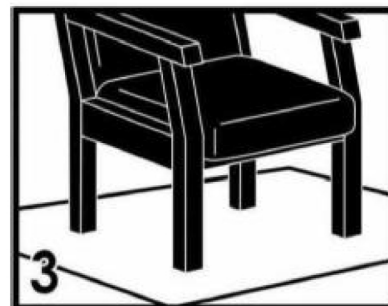

Use cardboard or carpet area when assembling furniture to prevent scratches. Make sure the furniture rests on a flat and level surface with each leg evenly touching the floor. No dragging of products/parts.

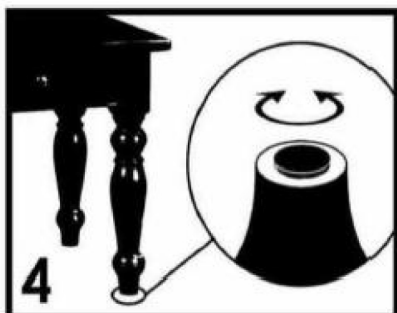

Some furniture comes with height adjustment knobs underneath each leg. To lower or to raise each leg, you need to turn clockwise or counterclockwise, respectively.

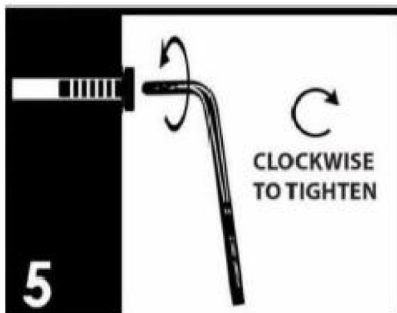

Make sure all parts are properly aligned, then use the appropriate hand tool to completely tighten the bolts or screws. Do not use power tools and do not overtighten.



Save the instructions and store the Allen wrench or any supplied tool for later maintenance. After two weeks, check and tighten any loose hardware and repeat again every six months thereafter.

IT IS THE USER'S RESPONSIBILITY TO MAINTAIN THE FURNITURE. THE HARDWARE MAY LOOSEN OVER TIME AND MAY CAUSE THE FURNITURE TO BE WOBBLY AND UNABLE TO SUPPORT ITS INTENDED WEIGHT CAPACITY. THIS MAY LEAD TO COLLAPSE AND MAY CAUSE SERIOUS INJURY.



**FAILURE TO FOLLOW THE GUIDELINES ABOVE MAY RESULT IN INJURY AND/OR PROPERTY DAMAGE.**



Before you begin, please read Page 2 of "Assembly and Care Advice".

And remember, do not tighten until each step is completed or instructed.

### Parts List



#1 x 1 pc.  
Seat frame



#2 x 1 pc.  
LHF Back cushion



#3 x 1 pc.  
RHF Back cushion



#4 x 1 pc.  
Middle back cushion



#5 x 1 pc.  
LED light plug

**TAKE OUT THE LED LIGHT PLUG FROM THE ARM STORAGE, THEN ATTACHED THE LED LIGHT PLUG TO THE POSITION AS SHOWN**



**TAKE OUT THE LED LIGHT PLUG (#5) FROM THE ARM STORAGE, THEN ATTACHED THE LED LIGHT PLUG (#5) TO THE POSITION AS SHOWN**

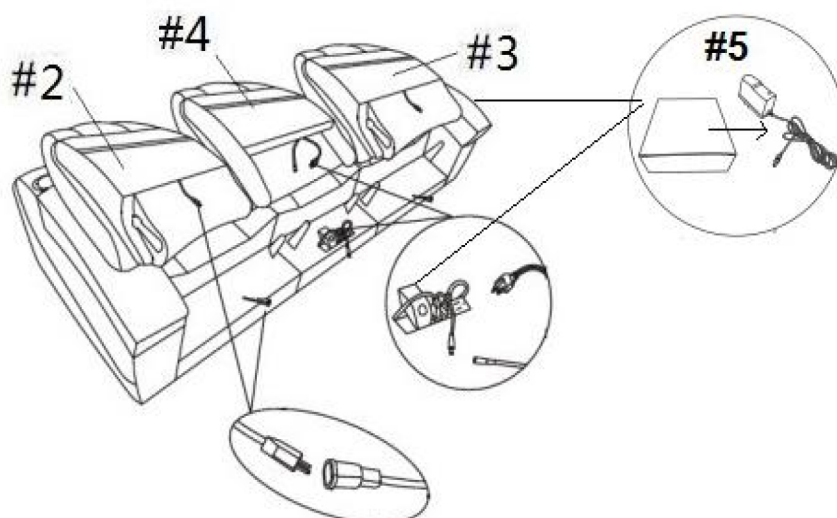

**Notes:** Follow the direction to connect the power cord as shown from drawing while insert the back rest.





**ALIGN THE FEMALE BRACKETS AT THE BACK (#2)(#3) (#4) ONTO THE MALE BRACKETS AT THE SEAT(#1) AND MAKE SURE IT IS FIXED IN POSITION SECURELY.**

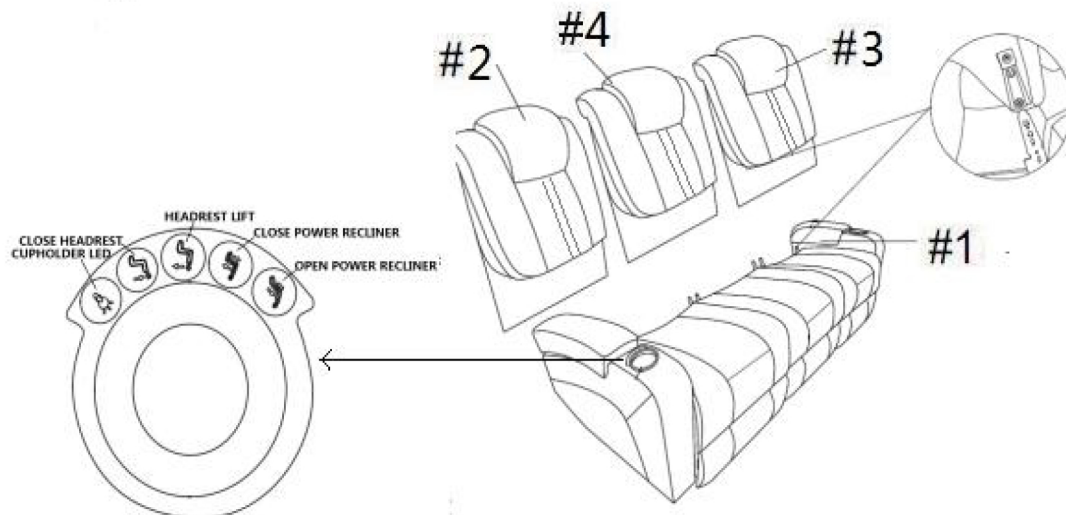

**Note: Press down seat back gently until you hear a “click” to make sure it is locked in place.**



**THE SOFA IS NOW READY.ENJOY!**

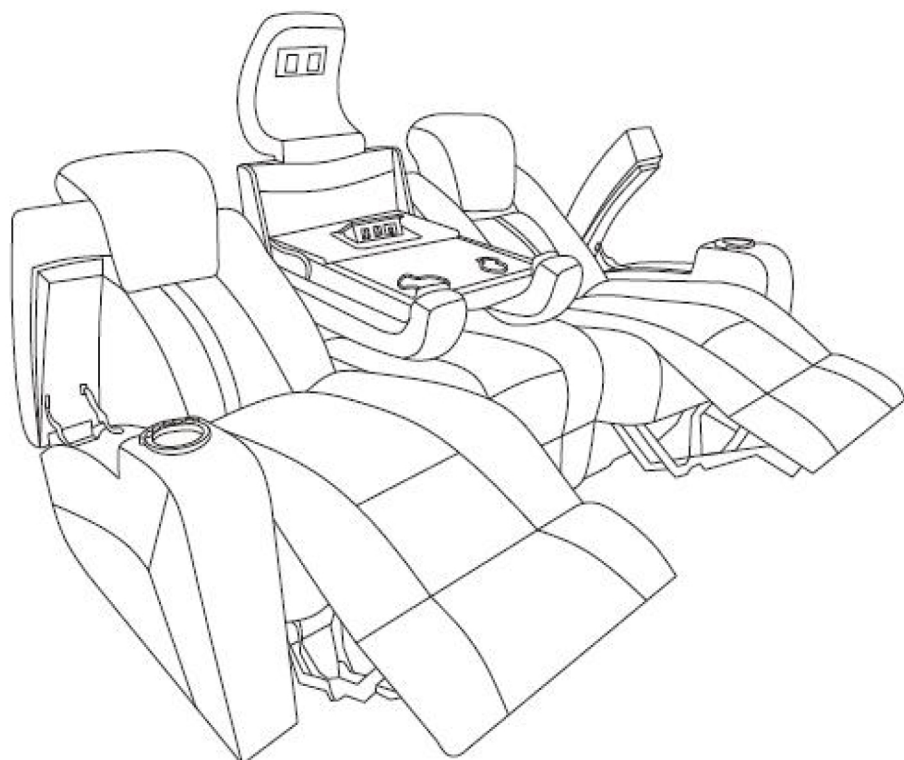

**ASSEMBLY IS COMPLETED**